

Libec - News Release for 2013 new products

18th February, 2013 - Libec, a brand of the HEIWA SEIKI KOGYO CO., LTD. is pleased to announce that it will launch new products. "RSPLUS", the flagship model of Libec tripod series lineup, offering new functions and technologies based on RS series. And "LX10", 100mm ball affordable tripod system for both ENG and Studio. New product will start to ship out of factory Japan from march 2013.

RSPLUS, the upper model of RS series

RSPLUS is a brand new tripod and pedestal system with 100mm ball head RHP75/85. The payload of RHP85 is 25kg, best match at Studio and Digital cinema application. It comes along with the normal plate, and long sliding plate is also equipped with RHP85 as standard. RHP75 is the ideal tripod head for ENG shoulder cameras with the 17kg payload and 30% lighter torque than RHP85.



RS
+PLUS
850
750

New "RSPLUS" features. Head, tripod and case.

Under the basic function of RS series, the head provides a perfect counterbalance between the camera weight and the innerspring tension at any tilt angle by adjusting the counterbalance knob.

To achieve this perfect counterbalance dramatically easier and more speedy, new technologies called "[Balance stabilizer mechanism](#)" and "[Smooth balancing system](#)" were adopted in RSPLUS. Libec's unique "Balance stabilizer mechanism" prevents even the slightest wobble on the image caused by the spring-back effect at a stopping tilt movement. In addition, this mechanism greatly simplifies the strict adjustment procedures needed for perfect balancing. The "Smooth balancing system" could stabilize the turning force efficiently and the knob can be turned with constant force and offers easy and speedy adjustments from beginning to end.

7step pan / tilt drag



Unique counterbalance technology

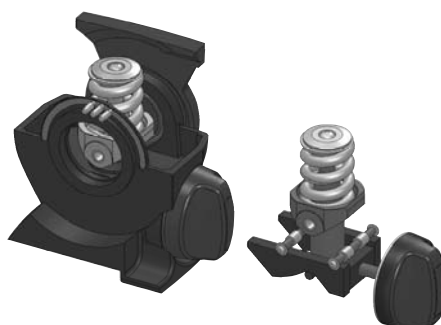

RHP85 with long sliding plate



And more, the camera plate is attachable and detachable with just one touch, promoting speedy and easy setup. The case is equipped with two wheels and can be pulled along by the side handle grip, which allows easy transportation on foot. This all-round tripod case is designed with high rigidity and can be safely transported as a check-in luggage during flight.

One touch release and attachment



Shell case with wheels RC-70 and RC-80



Libec - News Release for 2013 new products

-Specifications-

**RS
+PLUS**

850

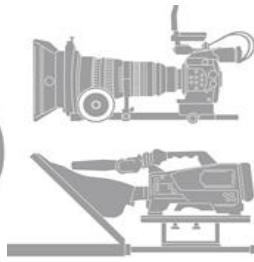

750

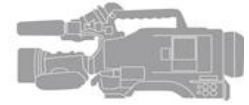

Counterbalance range	9 to 20kg / 20.0 to 44.0lb (C.G.125mm)	5.5 to 14kg / 12.0 to 31.0lb (C.G.125mm)
Payload	25kg / 55.0lb	17kg / 37.5lb
Counterbalance	Continuous	Continuous
Drag mode	7STEP	7STEP
Tilt angle	+90° / -70°	+90° / -70°
Temperature range	-40°C to +60°C / -40°F to +140°F	-40°C to +60°C / -40°F to +140°F
Bubble level	Illuminated	Illuminated
Camera plate	2 Sliding plates (Standard + Long)	Sliding plate
Sliding range	+/-55mm (Standard), +/-85mm(Long)	+/-55mm / 2.2"
Plate attachment	3/8" screw x 2	3/8" screw x 2
Spare screw	3/8" screw	3/8" screw
Weight	3.9kg / 8.6lb	3.8kg / 8.4lb

LX10 - Affordable system of 100mm ball tripod LX series

As a successor of LS-60/-70 systems, Libec will launch LX10 - the affordable tripod system for TV stations both ENG and studio with outstanding rigidity. Payload is 16kg/35lb. Adopted the newly designed tripod leg RT50B, the maximum height of LX10 system with floor spreader is 173.5cm/68.5" which is 13cm/5" higher than existing LS-60/-70 systems. LX10 Studio, system with dolly and dual extendable pan handle also available.

LX10 specifications

Payload	16kg / 35.0lb
Counterbalance	FIX
Drag mode	2STEP
Tilt angle	+85° / -65°
Temperature range	-20°C to +60°C / -4°F to +140°F
Bubble level	Non illuminated
Camera plate	Sliding plate
Sliding range	+/-50mm / 2.0"
Plate attachment	3/8" screw x 2
Spare screw	3/8" screw



Discontinued items

Along with the launch of new RSPLUS and LX10, existing LS-60, -70, -85, -100 systems will be discontinued by February 2013. Due to this lineup change, the color of Libec heads, tripod legs, spreaders, pedestals and dollies will be changed from grey to black, except for DV series and DL-2.

■ Discontinued and New products

LS-60 Systems < 13kg >	➔	LX10 Systems < 16kg >
LS-70 Systems < 15kg >		
LS-85 Systems < 17kg >	➔	RS-750 Systems < 17kg >
LS-100 Systems < 25kg >	➔	RS-850 Systems < 25kg >

Detailed specification, concept of new products and more information is available to check on Libec official website.

<http://www.libec-global.com>

Libec